

012543 Purge Air Adaptor for Sensor Mounts 1/4" BSP Inlet

Features

- Stainless Steel
- Removes Dust & Particles
- Foam Gasket
- Fixings Supplied

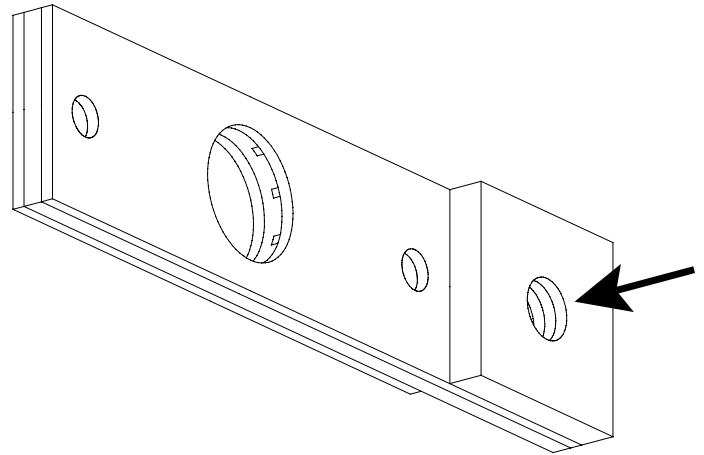

The purge air adaptor is intended to be mounted in front of a flame sensor viewing window to prevent obscuration by particles. Air is channelled from the air inlet at the side of the adaptor and exits around the central viewing hole.

The purge air adaptor has a 1/4" BSP air inlet. The air should be oil free and dry with a pressure range from 7psi (0.5Bar) to 50psi (3.5Bar). If the air is not required continuously to keep the viewing window clean then a pulse of air can be supplied at regular intervals.

Mounting Holes Required

